



City of Westminster

Licensing Sub-Committee Report

Item No:

Date:

Licensing Ref No:

Title of Report:

Report of:

Wards involved:

Policy context:

Financial summary:

Report Author:

Contact details

03 November 2022

22/07486/LIPN - New Premises Licence

Unit 34, Tube Level One, Paddington Square
144 Praed Street
London
W2 1HU

Director of Public Protection and Licensing

Hyde Park

City of Westminster Statement of Licensing Policy

None

Roxsana Haq
Senior Licensing Officer

Telephone: 020 7641 6500
Email: rhaq@westminster.gov.uk

1.	Application						
1-A	Applicant and premises						
Application Type:		New Premises Licence, Licensing Act 2003					
Application received date:		8 August 2022					
Applicant:		Amazon EU S.A.R.L.					
Premises:		Unit 34, Tube Level One, Paddington Square					
Premises address:		144 Praed Street London W2 1HU		Ward:		Hyde Park	
				Cumulative Impact Area:		None	
				Special Consideration Zone:		None	
Premises description:		According to the application form it is intended that these premises will operate as a retail store. The premises will comprise of one level and will operate as a general grocery and home goods store with a restricted area for storage and staff facilities at the rear.					
Premises licence history:		This application is for a new premises, and therefore no premises licence history exists.					
Applicant submissions:		<p>As part of the application the applicant provided the following information:</p> <p><i>“The application is submitted to authorise the sale of alcohol for consumption off the premises from a small designated display area in the store as indicated hatched red on the attached plan. The proposed hours and proportionate schedule of conditions looks to ensure the promotion of all four licensing objectives will be addressed once the premises are open”</i></p> <p><i>“In order to access the store customers will have an Amazon account, will scan a code on their smartphone at the entrance. In-store technology will automatically detect when products are taken from or returned to the shelves and keep track of them in a virtual basket. When the customer finishes shopping, they can leave the store. The customer receives a receipt and then the Amazon account is charged.”</i></p>					
Applicant amendments:		None.					

1-B	Proposed licensable activities and hours						
Sale by retail of alcohol				On or off sales or both:			Off sales.
Day:	Mon	Tues	Wed	Thur	Fri	Sat	Sun
Start:	08:00	08:00	08:00	08:00	08:00	08:00	09:00
End:	23:00	23:00	23:00	23:00	23:00	23:00	22:30
Seasonal variations/ Non-standard timings:			None				

Hours premises are open to the public							
Day:	Mon	Tues	Wed	Thur	Fri	Sat	Sun
Start:	07:00	07:00	07:00	07:00	07:00	07:00	07:00
End:	23:00	23:00	23:00	23:00	23:00	23:00	23:00
Seasonal variations/ Non-standard timings:		None					
Adult Entertainment:		None					

2.	Representations	
2-A	Responsible Authorities	
Responsible Authority:	Metropolitan Police Service	
Representative:	PC Adam Deweltz	
Received:	24 August 2022 (<i>Withdrawn 13 October 2022</i>)	
<p>With reference to the above, I am writing to inform you that the Metropolitan Police, as a responsible authority, are making a representation against this application. It is our belief that if granted, the application could undermine the Licensing Objectives in relation to The Prevention of Crime and Disorder. I have attached a list of conditions, which Police would like agreed.</p> <p>Following the agreement of proposed conditions, the Metropolitan Police Service withdrew their representation on 13 October 2022. The agreed conditions appear at Appendix 4</p>		
Responsible Authority:	Environmental Health Service	
Representative:	Dave Nevitt	
Received:	05 September 2022	
<p>I wish to make Representations on the following grounds: Representation is made in relation to the application, as the proposals are likely to increase the risk of Public Nuisance and may impact upon Public Safety.</p>		

2-B	Other Persons		
Name:		[REDACTED]	
Address and/or Residents Association:		South East Bayswater Residents Association (SEBRA)	
Status:	Valid	In support or opposed:	Opposed
Received:	24 August 2022		
<p>The South East Bayswater Residents Association (SEBRA) welcomes Amazon to Praed Street W2 and wishes them every success.</p> <p>Whilst much of application is acceptable, we have concern on a couple of points that could result in public nuisance, noise etc, crime and disorder.</p> <p>Firstly, we need clarification if Amazon sell beer & cider of more than 5.50% APV, as SEBRA seeks to have a condition preventing such sales, especially in and around Praed Street & Paddington Station where there is a serious street drinking problem.</p> <p>Secondly, we note opening hours are 0800 to 23.00 and sale of alcohol are same except Sunday is 0800 to 22.30 to comply with WCC Core Hours policy for off - sales of alcohol. How does applicant propose to stop sales of alcohol after 22.30?</p> <p>We would like a condition that the maximum floor area given over to alcohol sales is 15%, to prevent the premises becoming purely an off - licence.</p> <p>Likewise, spirits should be behind 'sales counter' as great amount of shoplifting in the area. We are happy in principle with the 'Challenge 25' condition, but are not clear how this can be complied with in the circumstances of this application.</p> <p>Most premises have a condition that lockable cabinets for alcohol after end of hours granted.</p> <p>Thirdly, we would like to know where deliveries to the store take place and trust it is at rear of premises.</p> <p>We await these details as, depending on where servicing takes place, we would want a condition to regulate the hours of deliveries, bearing in mind there are residents living opposite and hotel guests above the premises.</p> <p>Likewise, the same applies to collections of refuse & recycling, where we need to know exact details so we can agree a suitably hours condition.</p> <p>We await to hear on the information requested but are confident we should be able to agree conditions without the need to go to a Licencing hearing for determination.</p> <p>We are content for our concerns and contact details to be forwarded now to the applicant and hope that they will be in contact with us to resolve matters.</p>			

Name:		[REDACTED] (PWMVS)	
Address and/or Residents Association:		Paddington Waterways & Maida Vale Society [REDACTED] [REDACTED] [REDACTED]	
Status:	Valid	In support or opposed:	Opposed
Received:	30 August 2022		

Our comments are made as an Amenity Society recognised by Westminster City Council. We are officially charged with working towards the preservation and enhancement of the architectural and environmental quality of Little Venice, Maida Vale and the Paddington Waterway area (including planning and licensing issues).

We recognise that these premises are run as a business and we are aware that it has to be a viable operation, providing services for locals. We are very keen to ensure that an appropriate balance is maintained between the legitimate rights of business and the equally legitimate and important rights of residents.

Introduction

We do not object to a licence being granted, but we do have some concerns regarding certain aspects of the application which would need to be addressed before we would be in a position to withdraw this representation.

We have seen SEBRA's representation and agree with and endorse its content. Our representation is made on the basis that the likely impact of the application, if granted as applied for, would be to harm the licensing objectives, particularly that of prevention of public nuisance.

We would also ask that the Licensing Authority pay great attention to any comments submitted by local residents, and we would wish to support them in respect of valid concerns they may have.

The application and reasons for representation

The application seeks on and off sales of alcohol to 'core hours'.

We believe that the premises will be an Amazon 'general grocery and home goods' store on the site of the old McDonald's fast food restaurant.

We have the following points to raise.

1. The plan is not very clear, although there is a rear access – would deliveries/waste through be at the rear or on Praed Street?
2. The operational model is intriguing and novel. However it does raise concerns re: sale of alcohol. How is age verification achieved? Given how important this is, we expect robust measures to be in place.
3. We would like a limit on floor area given over to sale of alcohol, to prevent the premises being an off licence with no other products.
4. Sale of super strength alcohol (beer/lager/cider) is a concern given street drinking problems in the area – we ask for a condition preventing this.
5. Similarly, there should be no self service of spirits.
6. Alcohol should be safely locked away outside the hours for alcohol sales.

Conclusion

We are also aware that applications can be amended to take into account concerns raised by responsible authorities or other persons. Please let us know if any amendments are made to this application so that we can consider if they resolve our concerns and, if appropriate, liaise with local residents.

If a hearing takes place, we will endeavour to attend. Or appoint Richard Brown to represent us.

3.	Policy & Guidance
The following policies within the City of Westminster Statement of Licensing Policy apply:	
Hours Policy HRS1 applies	<p>A. Applications within the core hours set out below in this policy will generally be granted for the relevant premises uses, subject to not being contrary to other policies in the Statement of Licensing Policy.</p> <p>C. For the purpose of Clauses A and B above, the Core Hours for applications for each premises use type as defined within this policy are:</p> <p>11a. Shops (all licensable activities that are provided as ancillary to the primary use of the premises as a shop except the off sale of alcohol) Monday to Thursday: 9am to 11.30pm. Friday and Saturday: 9am to Midnight. Sunday: 9am to 10.30pm. Sundays immediately prior to a bank holiday: 9am to Midnight.</p> <p>11b. Shops (off-sales of alcohol where it forms either the ancillary or primary use of the premises) Monday to Saturday: 8am to 11pm. Sunday: 9am to 10.30pm.</p> <p>D. Core hours are when customers are permitted to be on the premises and therefore the maximum opening hours permitted will be to the same start and terminal hours for each of the days where licensable activity is permitted.</p> <p>E. For the purposes of this policy, 'premises uses' are defined within the relevant premises use policies within this statement.</p> <p>Note: The core hours are for all licensable activities but if an application includes late night refreshment, then the starting time for that licensable activity will be 11pm.</p>
Shops Policy SHP1 applies	<p>A. Applications for a shop outside the West End Cumulative Impact Zone will generally be granted subject to:</p> <ol style="list-style-type: none"> 1. The application meeting the requirements of policies CD1, PS1, PN1 and CH1. 2. The hours for licensable activities are within the council's Core Hours Policy HRS1. 3. The operation of any delivery services for alcohol meeting the council's Ancillary Alcohol and/or Late-night Refreshment Delivery Service Policy DEL1. 4. The applicant having taken account of the Special Consideration Zone Policy SCZ1 if the premises are located within a designated zone. 5. The application and operation of the venue meeting the definition of a shop in Clause C.

	<p>C. For the purposes of this policy:</p> <p>1. A shop is defined as a stall, vehicle, vessel, temporary structure, building or part of a stall, vehicle, vessel, temporary structure or building where the primary activity is the sale of goods or services to customers upon payment.</p> <p>2. The licensable activities for the sale of alcohol for consumption on the premises, regulated entertainment and/or late night refreshment must be ancillary to the primary use of the premises as a shop.</p> <p>3. The licensable activity of the sale of alcohol for consumption off the premises must be an ancillary function to the primary use of the premises unless that primary use is to sell alcohol for consumption off the premises, e.g. a traditional off licence.</p>
--	--

4. Equality Implications

The Council in its capacity as Licensing Authority has a duty to have regard to its public sector equality duty under section 149 of the Equality Act 2010. In summary, section 149 provides that a Public Authority must, in the exercise of its functions, have due regard to the need to:

- (a) eliminate discrimination harassment, victimisation and any other conduct that is prohibited by or under this Act;
- (b) advance equality of opportunity between persons who share a relevant protected characteristic and persons who do not share it; and
- (c) foster good relations between persons who share a relevant protected characteristics and persons who do not share it.

Section 149 (7) of the Equality Act 2010 defines the relevant protected characteristics as age, disability, gender reassignment, marriage and civil partnership, pregnancy and maternity, race, religion or belief, sex, and sexual orientation.

5.	Appendices
Appendix 1	Premises plans
Appendix 2	Applicant supporting documents
Appendix 3	Premises history
Appendix 4	Proposed conditions
Appendix 5	Residential map and list of premises in the vicinity

Report author:	Roxsana Haq Senior Licensing Officer
Contact:	Telephone: 020 7641 6500 Email: rhaq@westminster.gov.uk

If you have any queries about this report or wish to inspect one of the background papers please contact the report author.

Background Documents – Local Government (Access to Information) Act 1972

1	Licensing Act 2003	N/A
2	City of Westminster Statement of Licensing Policy	October 2021
3	Amended Guidance issued under section 182 of the Licensing Act 2003	April 2018
4	Metropolitan Police Service representation	24 August 2022 (withdrawn 13 October 2022)
5	Environmental Health Service representation	5 September 2022
6	Interested Party representation (1)	24 August 2022
7	Interested Party representation (2)	30 August 2022

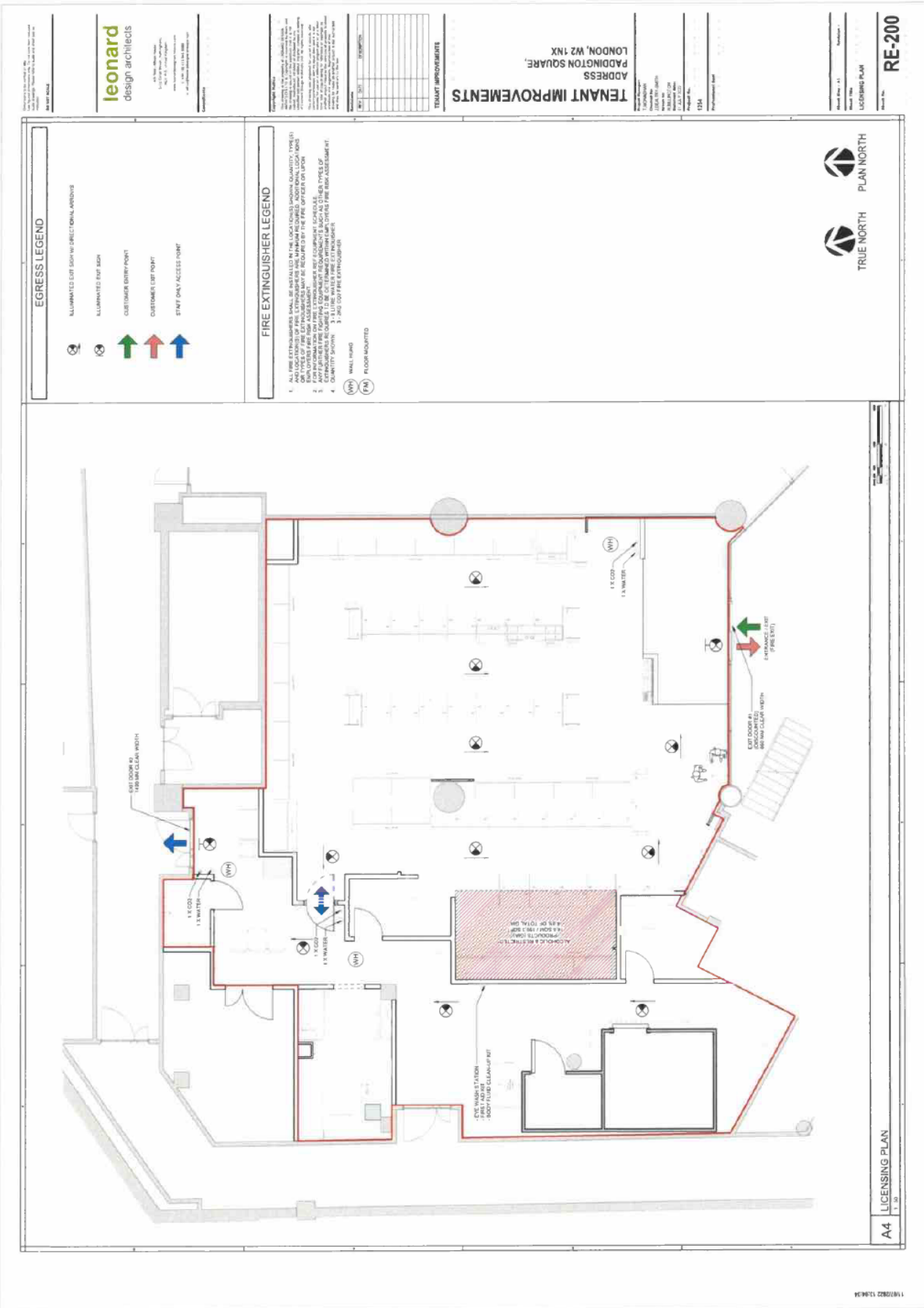

Applicant Supporting Documents

Appendix 2

There are no supporting documents provided by the applicant.

Premises History

Appendix 3

There is no licence or appeal history for the premises.

**CONDITIONS CONSISTENT WITH THE OPERATING SCHEDULE AND CONDITIONS
PROPOSED BY A PARTY TO THE HEARING**

When determining an application for a new premises licence under the provisions of the Licensing Act 2003, the licensing authority must, unless it decides to reject the application, grant the licence subject to the conditions which are indicated as mandatory in this schedule.

At a hearing the licensing authority may, in addition, and having regard to any representations received, grant the licence subject to such conditions which are consistent with the operating schedule submitted by the applicant as part of their application, or alter or omit these conditions, or add any new condition to such extent as the licensing authority considers necessary for the promotion of the licensing objectives.

This schedule lists those conditions which are consistent with the operating schedule, or proposed as necessary for the promotion of the licensing objectives by a responsible authority or an interested party as indicated. These conditions have not been submitted by the licensing service but reflect the positions of the applicant, responsible authority or interested party and have not necessarily been agreed

Mandatory Conditions

1. No supply of alcohol may be made at a time when there is no designated premises supervisor in respect of this licence.
2. No supply of alcohol may be made at a time when the designated premises supervisor does not hold a personal licence or the personal licence is suspended.
3. Every supply of alcohol under this licence must be made or authorised by a person who holds a personal licence.
4.
 - (1) The responsible person must ensure that staff on relevant premises do not carry out, arrange or participate in any irresponsible promotions in relation to the premises.
 - (2) In this paragraph, an irresponsible promotion means any one or more of the following activities, or substantially similar activities, carried on for the purpose of encouraging the sale or supply of alcohol for consumption on the premises—
 - (a) games or other activities which require or encourage, or are designed to require or encourage, individuals to;
 - (i) drink a quantity of alcohol within a time limit (other than to drink alcohol sold or supplied on the premises before the cessation of the period in which the responsible person is authorised to sell or supply alcohol), or
 - (ii) drink as much alcohol as possible (whether within a time limit or otherwise);
 - (b) provision of unlimited or unspecified quantities of alcohol free or for a fixed or discounted fee to the public or to a group defined by a particular characteristic in a manner which carries a significant risk of undermining a licensing objective;
 - (c) provision of free or discounted alcohol or any other thing as a prize to encourage or reward the purchase and consumption of alcohol over a period of 24 hours or

less in a manner which carries a significant risk of undermining a licensing objective;

- (d) selling or supplying alcohol in association with promotional posters or flyers on, or in the vicinity of, the premises which can reasonably be considered to condone, encourage or glamorise anti-social behaviour or to refer to the effects of drunkenness in any favourable manner;
 - (e) dispensing alcohol directly by one person into the mouth of another (other than where that other person is unable to drink without assistance by reason of a disability).
5. The responsible person must ensure that free potable water is provided on request to customers where it is reasonably available.
6. (1) The premises licence holder or club premises certificate holder must ensure that an age verification policy is adopted in respect of the premises in relation to the sale or supply of alcohol.
- (2) The designated premises supervisor in relation to the premises licence must ensure that the supply of alcohol at the premises is carried on in accordance with the age verification policy.
- (3) The policy must require individuals who appear to the responsible person to be under 18 years of age (or such older age as may be specified in the policy) to produce on request, before being served alcohol, identification bearing their photograph, date of birth and either—
- (a) a holographic mark, or
 - (b) an ultraviolet feature.
7. The responsible person must ensure that—
- (a) where any of the following alcoholic drinks is sold or supplied for consumption on the premises (other than alcoholic drinks sold or supplied having been made up in advance ready for sale or supply in a securely closed container) it is available to customers in the following measures—
 - (i) beer or cider: ½ pint;
 - (ii) gin, rum, vodka or whisky: 25 ml or 35 ml; and
 - (iii) still wine in a glass: 125 ml;
 - (b) these measures are displayed in a menu, price list or other printed material which is available to customers on the premises; and
 - (c) where a customer does not in relation to a sale of alcohol specify the quantity of alcohol to be sold, the customer is made aware that these measures are available.

A responsible person in relation to a licensed premises means the holder of the premise licence in respect of the premises, the designated premises supervisor (if any) or any individual aged 18 or over who is authorised by either the licence holder or designated premises supervisor. For premises with a club premises certificate, any member or officer of the club present on the premises in a capacity that which enables him to prevent the supply of alcohol.

8(i) A relevant person shall ensure that no alcohol is sold or supplied for consumption on or off the premises for a price which is less than the permitted price.

8(ii) For the purposes of the condition set out in paragraph 8(i) above -

(a) "duty" is to be construed in accordance with the Alcoholic Liquor Duties Act 1979;

(b) "permitted price" is the price found by applying the formula -

$$P = D + (D \times V)$$

Where -

(i) P is the permitted price,

(ii) D is the amount of duty chargeable in relation to the alcohol as if the duty were charged on the date of the sale or supply of the alcohol, and

(iii) V is the rate of value added tax chargeable in relation to the alcohol as if the value added tax were charged on the date of the sale or supply of the alcohol;

(c) "relevant person" means, in relation to premises in respect of which there is in force a premises licence -

(i) the holder of the premises licence,

(ii) the designated premises supervisor (if any) in respect of such a licence, or

(iii) the personal licence holder who makes or authorises a supply of alcohol under such a licence;

(d) "relevant person" means, in relation to premises in respect of which there is in force a club premises certificate, any member or officer of the club present on the premises in a capacity which enables the member or officer to prevent the supply in question; and

(e) "value added tax" means value added tax charged in accordance with the Value Added Tax Act 1994.

8(iii). Where the permitted price given by Paragraph 8(ii)(b) above would (apart from this paragraph) not be a whole number of pennies, the price given by that sub-paragraph shall be taken to be the price actually given by that sub-paragraph rounded up to the nearest penny.

8(iv). (1) Sub-paragraph 8(iv)(2) below applies where the permitted price given by Paragraph 8(ii)(b) above on a day ("the first day") would be different from the permitted price on the next day ("the second day") as a result of a change to the rate of duty or value added tax.

(2) The permitted price which would apply on the first day applies to sales or supplies of alcohol which take place before the expiry of the period of 14 days beginning on the second day.

Conditions consistent with the operating schedule

9.
 - a) The premises shall install and maintain a comprehensive CCTV system as per the minimum requirements of the Westminster Police Licensing Team.
 - b) All entry and exit points will be covered enabling frontal identification of every person entering in any light condition.
 - a) The CCTV system shall continually record whilst the premises is open for licensable activities and during all times when customers remain on the premises.
 - b) All recordings shall be stored for a minimum period of 31 days with date and time stamping.
 - c) Viewing of recordings shall be made available immediately upon the request of Police or authorised officer throughout the entire 31-day period.
10. At all times when the premises are open for the purposes of licensable activities a suitably trained member of staff shall be present to assist the police or an authorised officer in obtaining the CCTV footage.
11. Signage shall be displayed at the premises advising customers that CCTV is in use at the premises.
12. All alcohol made available for sale shall be in sealed containers only.
13. A refusals book (electronic or hard copy) shall be kept at the premises to record details of all refusals to sell alcohol. This book shall contain the date and time of the incident, the name of the staff member who refused the sale and reasons the sale was refused. The book shall be made available to police and authorised Council officers on request.
14. Challenge 25 proof of age scheme shall be operated at the premises where the only acceptable forms of identification are recognised photographic identification cards, such as a driving licence, passport or proof of age card with the PASS Hologram.
15. At all times that the designated alcohol is open and alcohol is available for sale there shall be a dedicated member of staff present to supervise the alcohol area and carry out Challenge 25 Age Verification checks on customers entering that area.
16. All staff are to be trained in their responsibilities under the Licensing Act 2003. Written records of this training shall be retained and made available to police and authorised Council officers on request.
17. Signage shall be displayed at the premises advising customers of the proof of age policy in force at the premises.

Conditions proposed by the Metropolitan Police Service and agreed by the applicant.

18. A staff member from the premises who is conversant with the operation of the CCTV system shall be on the premises at all times when the premises is open. This staff member must be able to provide a Police or authorised council officer copies of recent CCTV images or data with the absolute minimum of delay when requested
19. An incident log shall be kept at the premises and made available on request to an authorised officer of the City Council or the Police. It must be completed within 24 hours of the incident and will record the following:
 - (a) all crimes reported to the venue
 - (b) all ejections of patrons
 - (c) any complaints received concerning crime and disorder
 - (d) any incidents of disorder
 - (e) any faults in the CCTV system
 - (f) any refusal of the sale of alcohol
 - (g) any visit by a relevant authority or emergency service
20. All sales of alcohol for consumption off the premises shall be in sealed containers only and shall not be consumed on the premises.
21. No super-strength beer, lager, cider or spirit mixtures of 5.5% ABV (alcohol by volume) or above shall be sold at the premises, except for premium products in bottles or cans.
22. The Premises Licence Holder shall undertake a risk assessment to determine whether or not an SIA licensed door supervisor is required during football days and the bank holiday weekend of Notting Hill Carnival. This risk assessment will be available to the licensing authority and Police upon request.
23. No more than 15% of the sales area shall be used at any one time for the display of alcohol.
24. No miniature bottles of spirits of 20 cl or below shall be sold from the premises, save for premium products, boxed gifts and seasonal packs.

Conditions proposed by the Interested Parties

25. Outside of the hours authorised for the sale of alcohol and whilst the premises are open to the public, the licence holder shall ensure that all alcohol within the premises (including alcohol behind the counter) is secured in a *closed off secure area*, locked store room or behind locked grilles, locked screens or locked cabinet doors so as to prevent access to the alcohol by both customers and staff.
26. Prominent signage indicating the permitted hours for the sale of alcohol shall be displayed so as to be visible before entering the premises, where alcohol is on public display, and at the point of sale.

Conditions proposed by the Environmental Health Service

27. No licensable activities shall take place at the premises until the premises has been assessed as satisfactory by the Environmental Health Consultation Team at which time this condition shall be removed from the Licence by the licensing authority.

144 Praed Street London W2 1HU

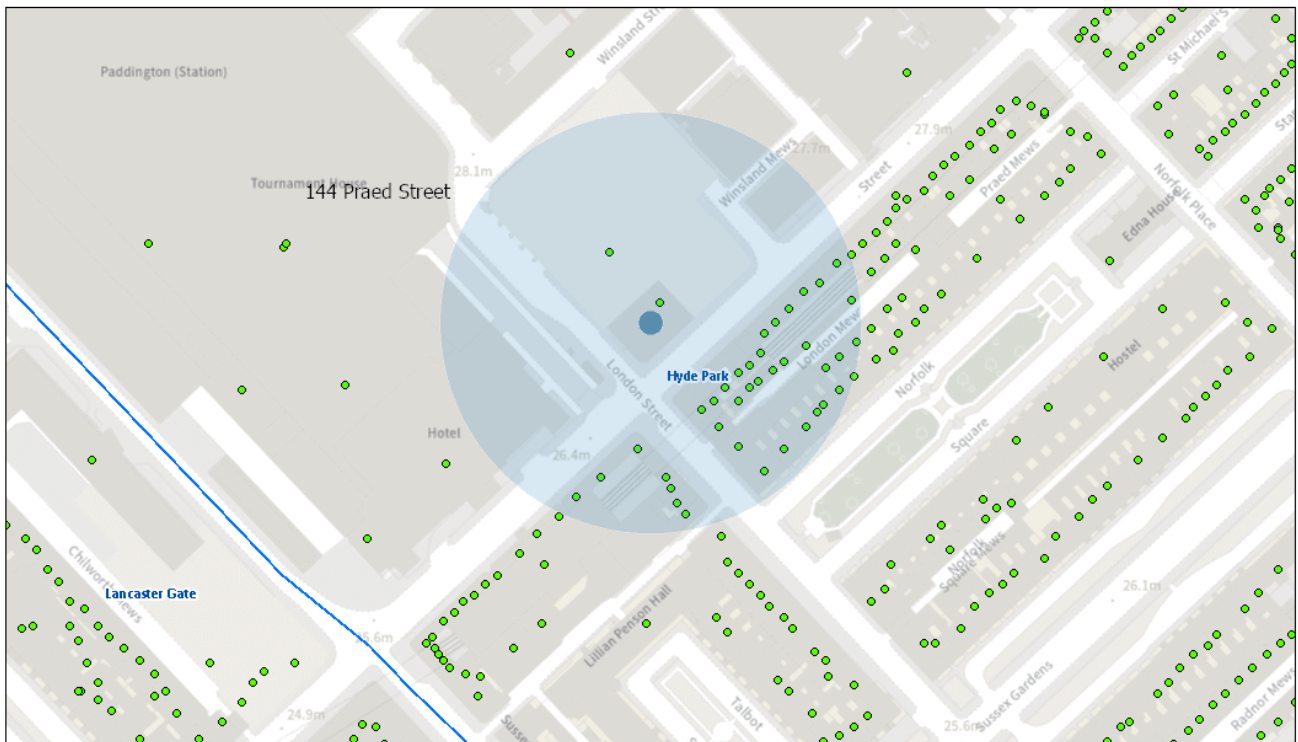

05/10/2022, 15:43:37

- Property Mailing List
- Borough Boundary - Mask
- Ward Boundaries
- Ward Labels
- Borough Boundary - Detailed

1:1,654
0 0.01 0.03 0.05 mi
0 0.02 0.04 0.08 km

Resident Count: 40

Licensed premises within 75 metres of 144 Praed Street, London W2 1HU

Licence Number	Trading Name	Address	Premises Type	Time Period
21/06556/LIPDPS	Frankie & Benny	Ground Front 144 Praed Street London W2 1HU	Hotel, 4+ star or major chain	Sunday; 08:00 - 00:00 Monday to Saturday; 08:00 - 00:30
13/02856/LIPN	Tavolina	Basement And Ground Floor 159 Praed Street London W2 1RL	Cafe	Sunday; 10:00 - 22:30 Monday to Saturday; 08:00 - 23:30
06/11392/WCCMAP	Paddington Gift Shop	Ground 161 Praed Street London W2 1RL	Restaurant	Sunday; 10:00 - 22:30 Monday to Saturday; 08:00 - 23:00
21/07202/LIPN	McDonald's	161 Praed Street London W2 1RL	Restaurant	Monday to Sunday; 06:00 - 00:00
08/04611/LIPN	Burger King (UK) Ltd	27 London Street London W2 1HH	Takeaway food outlet	Monday to Sunday; 07:00 - 02:00
21/00817/LIPN	Restaurant At Units 34/35/41	Development Site At 31 London Street, 9 Winsland Mews And 128-144 Praed Street London	Restaurant	Sunday; 09:00 - 23:00 Monday to Thursday; 08:00 - 23:30 Friday to Saturday; 08:00 - 00:00
21/00824/LIPN	Units 36 & 42	Development Site At 31 London Street, 9 Winsland Mews And 128-144 Praed Street London	Restaurant	Sunday; 09:00 - 23:00 Monday to Thursday; 08:00 - 23:30 Friday to Saturday; 08:00 - 00:00
21/00850/LIPN	17th And 18th Floors	Development Site At 31 London Street, 9 Winsland Mews And 128-144 Praed Street London	Restaurant	Sunday; 09:00 - 22:30 Monday to Thursday; 09:00 - 23:30 Friday to Saturday; 09:00 - 00:00

21/00845/LIPN	Unit 1	Development Site At 31 London Street, 9 Winsland Mews And 128-144 Praed Street London	Restaurant	Sunday; 09:00 - 23:00 Monday to Thursday; 08:00 - 23:30 Friday to Saturday; 08:00 - 00:00
21/00847/LIPN	Restaurant At Units 39 And 45	Development Site At 31 London Street, 9 Winsland Mews And 128-144 Praed Street London	Restaurant	Sunday; 09:00 - 23:00 Monday to Thursday; 08:00 - 23:30 Friday to Saturday; 08:00 - 00:00
21/00849/LIPN	Units 37 43	Development Site At 31 London Street, 9 Winsland Mews And 128-144 Praed Street London	Restaurant	Sunday; 09:00 - 23:00 Monday to Thursday; 08:00 - 23:30 Friday to Saturday; 08:00 - 00:00
21/00848/LIPN	Restaurant Units 38 To 44	Development Site At 31 London Street, 9 Winsland Mews And 128-144 Praed Street London	Restaurant	Sunday; 09:00 - 23:00 Monday to Thursday; 08:00 - 23:30 Friday to Saturday; 08:00 - 00:00
21/00851/LIPN	Bar At Units 2 And 46 And Rooftop Terrace At Paddington Squa	Development Site At 31 London Street, 9 Winsland Mews And 128-144 Praed Street London	Wine bar	Sunday; 09:00 - 22:30 Monday to Thursday; 10:00 - 23:30 Thursday to Saturday; 10:00 - 00:00
20/07076/LIPV	Yahala	26 London Street London W2 1HH	Restaurant	Sunday; 12:00 - 00:00 Monday to Saturday; 10:00 - 00:30
19/06223/LIPCH	Kentucky Fried Chicken Express	149 Praed Street London	Restaurant	Monday to Sunday; 23:00 - 03:00
21/07443/LIPT	Subway	147 Praed Street London W2 1RL	Restaurant	Monday to Sunday; 00:00 - 00:00
16/07456/LIPN	Patsons News	3 - 4 London Street London W2 1HL	Shop	Monday to Sunday; 08:00 - 23:00

22/05988/LIPVM	Olivers Steakhouse	Basement 25 London Street London W2 1HH	Public house or pub restaurant	Monday; 08:00 - 23:30 Tuesday; 08:00 - 23:30 Wednesday; 08:00 - 23:30 Thursday; 08:00 - 23:30 Friday; 08:00 - 23:30 Saturday; 08:00 - 23:30 Sunday; 08:00 - 23:30 Monday to Thursday; 10:00 - 23:30 Friday to Saturday; 10:00 - 00:00
18/04895/LIPDPS	Dickens Tavern	Basement 25 London Street London W2 1HH	Pub or pub restaurant with lodge	Sunday; 07:00 - 22:30 Monday to Thursday; 07:00 - 23:30 Friday to Saturday; 07:00 - 00:00
19/07429/LIPVM	Pilgrim Hotel	25 London Street London W2 1HH	Hotel, 3 star or under	Monday; 00:00 - 00:00 Tuesday; 00:00 - 00:00 Wednesday; 00:00 - 00:00 Thursday; 00:00 - 00:00 Friday; 00:00 - 00:00 Saturday; 00:00 - 00:00 Sunday; 00:00 - 00:00
19/16871/LIPDPS	Budgens	171-173 Praed Street London W2 1RH	Shop	Sunday; 10:00 - 05:00 Monday to Saturday; 08:00 - 05:00
13/02699/LIPN	La Tazza Cafe	Basement And Ground Floor 143 Praed Street London W2 1RL	Cafe	Monday to Sunday; 07:00 - 23:00
11/09256/LIPN	Lite Bite	Basement Front And Ground Floor 7 London Street London W2	Restaurant	Sunday; 07:00 - 23:00 Monday to Saturday; 07:00 - 23:30

		1HL		
20/07490/LIPCH	Aberdeen Steak House	163-167 Praed Street London W2 1RH	Restaurant	Sunday; 10:00 - 00:00 Monday to Saturday; 10:00 - 01:00 Sundays before Bank Holidays; 10:00 - 01:00